

Product Description

Coolview® CLED50SX

Coolview CLED50 examination lights are the perfect light source for a wide range of procedures. Providing a high intensity, bright natural light, Coolview CLED50SX is perfect for medical consultation in primary care and medical clinics.



Product Images



Desk mounted CLED50SXDP

Desk mount



Wall Mount



Backplate Wall Mount



Pendant Pole
Clamp Mounts



Rail Mount



Mobile Base



Product Features

Powerful Light Intensity

Coolview CLED50SX emits 50,000 Lux of bright natural light at 0.5 m providing an intense, clear light source for use in general consultation areas.

Perfect Colour

The colour corrected light source with a colour temperature of 4,400 K allows for accurate representation of tissue during examination.

CLED50SX reproduces all of the visible colours naturally and accurately. Excellent colour rendition is achieved that supports accurate tissue differentiation (R9) and clear identification of changes in skin tones (R13).

Infection Control

The fully enclosed light head is sealed to protect from dust and light liquid ingress.

Mountings

The Coolview CLED50SX Examination Light operates on a flexible arm offering precise positioning and stability. The Light can be specified for mounting on the Wall (with or without Backplate), Desk, "Medirail" or on a Mobile Wheeled Base.

Model Number	Description
CLED50SXB	Coolview CLED50SX Flexible Arm Wall Mounted with Backplate Examination Lamp with UK Plug Lead
CLED50SXD	Coolview CLED50SX Flexible Arm Desk Mounted with Lamp with UK Plug Lead
CLED50SXM	Coolview CLED50SX Flexible Arm Mobile Mounted with Lamp with UK Plug Lead
CLED50SXR	Coolview CLED50SX Flexible Arm Rail Mounted with Lamp with UK Plug Lead
CLED50SXW	Coolview CLED50SX Flexible Arm Wall Mounted with Lamp with UK Plug Lead
CLED50XA38P	Coolview CLED50SX Flexible Arm Pendant Ø38mm-Pole Clamp Mounted with Lamp with UK Plug Lead
CLED50XA25P	Coolview CLED50SX Flexible Arm Pendant Ø25mm-Pole Clamp Mounted with Lamp with UK Plug Lead

Technical Performance Information

Unless otherwise stated: All linear dimensions in mm, angles in degrees (±5°) and weights in kg

General System Information	CLED50SXB	CLED50SXD	CLED50SXM	CLED50SXR	CLED50SXW	CLED50XA38P	CLED50XA25P
Lamphead/Arm Type	CLED50SX						
Mount Type	Backplate Wall Mount	Desk Mount	Mobile Base	Rail Mount	Wall Mount	Ø38mm Pendant Pole Clamp	Ø25mm Pendant Pole Clamp
Weight (kg)	1.8	1.7	8.8	1.5	1.4	1.7	1.7
Medical Device Classification	I						
Electrical Classification	II						
Type of luminaire	Examination (Luminaire for diagnosis)						
Conformity	CE (EU MDR 2017/745); EN/IEC 60601-1; EN/IEC 60601-2-41; EN/IEC 60601-1-2						
Additional Information	Power Lead supplied loose with UK plug						

Mount	Backplate Wall Mount	Desk Mount	Mobile Base	Rail	Wall Mount	Ø38mm Pendant Pole Clamp	Ø25mm Pendant Pole Clamp
Mount Size HxWxD (mm)	130 x 130 x 70	150 to 210 x70 x40	1000xØ700	96 (max) x62 x48	91 x59 x67	124 x58 x33	114 x58 x33
Weight of Mount (kg)	0.5	0.35	7.5	0.2	0.1	0.34	0.32
Fixing Type	Permanent	Moveable	Mobile	Moveable	Permanent	Semi-Permanent	
Available Rotation Lateral about Spindle (±5°)	180°	360°	360°	360° max	180°	330°	330°
Interface Orientation	Vertical Up	Vertical Up	Vertical Up	Vertical Up	Vertical Up	Vertical Up	Vertical Up
Colour	White/Grey	Black	Grey/White	Silver	Grey	Silver	Silver
Material	Steel/Plastic	Polyamide / Steel	Steel/Plastic	Aluminium	Plastic	Aluminium	Aluminium

Examination Lamphead/Arm	CLED50SX
Description	LED Examination Light
Light On/Off Switch Location	Rocker Switch on Arm
Arm Type	Flexible
Fastener Type	Ø16 mm Pin
Base Joint Type and Angle (°)	Articulating 180°
Base Rotation about Fastener (°)	360 (max)
Elbow Angle (°)	n/a
Arm Reach	800
Lamphead Diameter (mm) Approx	90
Lamphead Pitch (°)	n/a
Lamphead Roll (°)	300°
Lamphead & Arm Weight (kg) Approx	1.3
Power Supply Lead(s) [Plug]	1.8 m [UK]

Lamphead/Arm Electrical Data	CLED50SX
Primary Power Supply	100-240VAC 50/60 Hz
Secondary Power Supply Unit	Integral 24V DC
Power Consumption @ Nominal Intensity	10.5-13 W
Ingress Protection Rating	IP20

Lamphead Photometric Data *-10% / +20%	CLED50
Central Illuminance @ 0.5 metre (Lux max *)	50,000
Field diameter D10 @ 0.5 meter (mm)	180
Field diameter D50 @ 0.5 meter (mm)	90
Nominal Working Distance from Lamphead m	0.5
Colour rendition Ra (Av R1-R8)	>93
Colour rendition R9 (red)	>90
Colour rendition R13	98
Colour Temperature (K)	4,400
Number & Type of Lights per Lamphead	7 LED
LED life (hours)	50,000



- A: Luminaire with spring-arm
B: Power cable
C: Mount

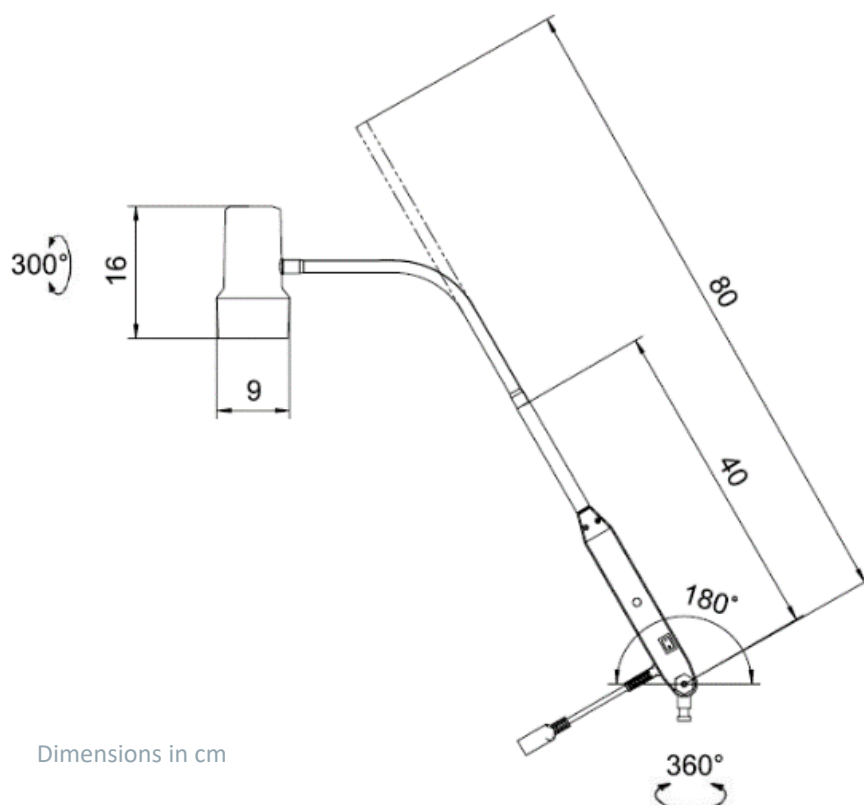

Dimensions in cm